

CCS Technical Documentation

RH-44 Series Transceivers

Parts Lists

Contents

	Page No
Exploded View.....	4
Assembly Parts List	4
D-cover Assembly Parts	5
Parts Lists	6
RH-44 (3586i) — EDMS Issue 4.0 Code: 0202159	6
RH-44 (3586) — EDMS Issue 4.0 Code: 0202160	22

Exploded View

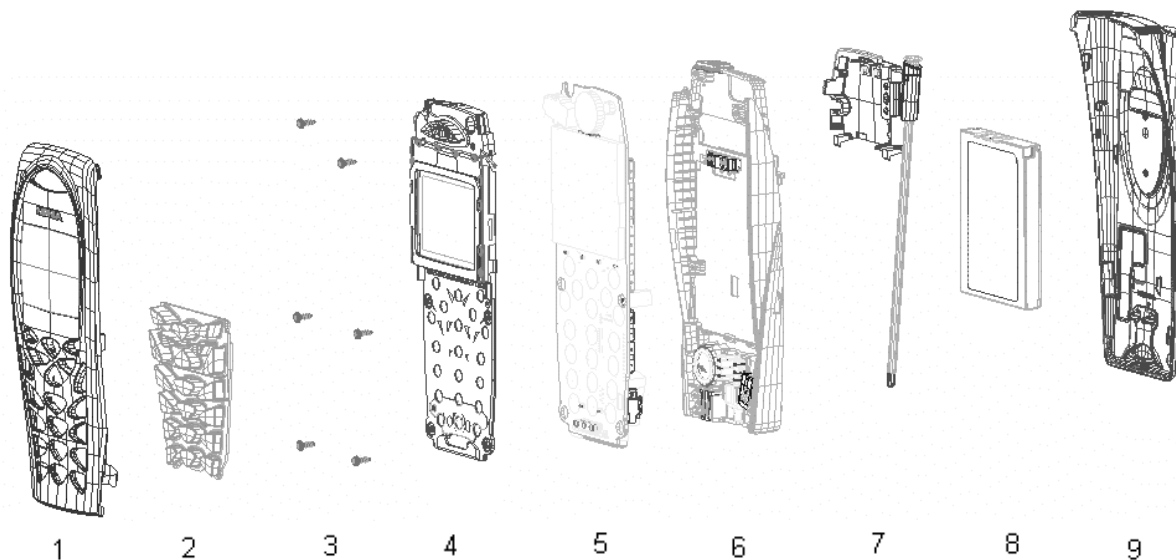

Assembly Parts List

Item	Qty	Description	Product code
1	1	A-cover assembly	9491060
2	1	Keymat	9790746
3	6	Screws	6297701
4	1	Display assembly	9481106
5	1	PWB module: 3586 (without GPS) 3586i (with GPS)	0202160 0202159
6	1	D-cover assembly	9491455
7	1	Antenna assembly	0660284
8	1	Battery	0670348
9	1	B-cover assembly	9491113

D-cover Assembly Parts

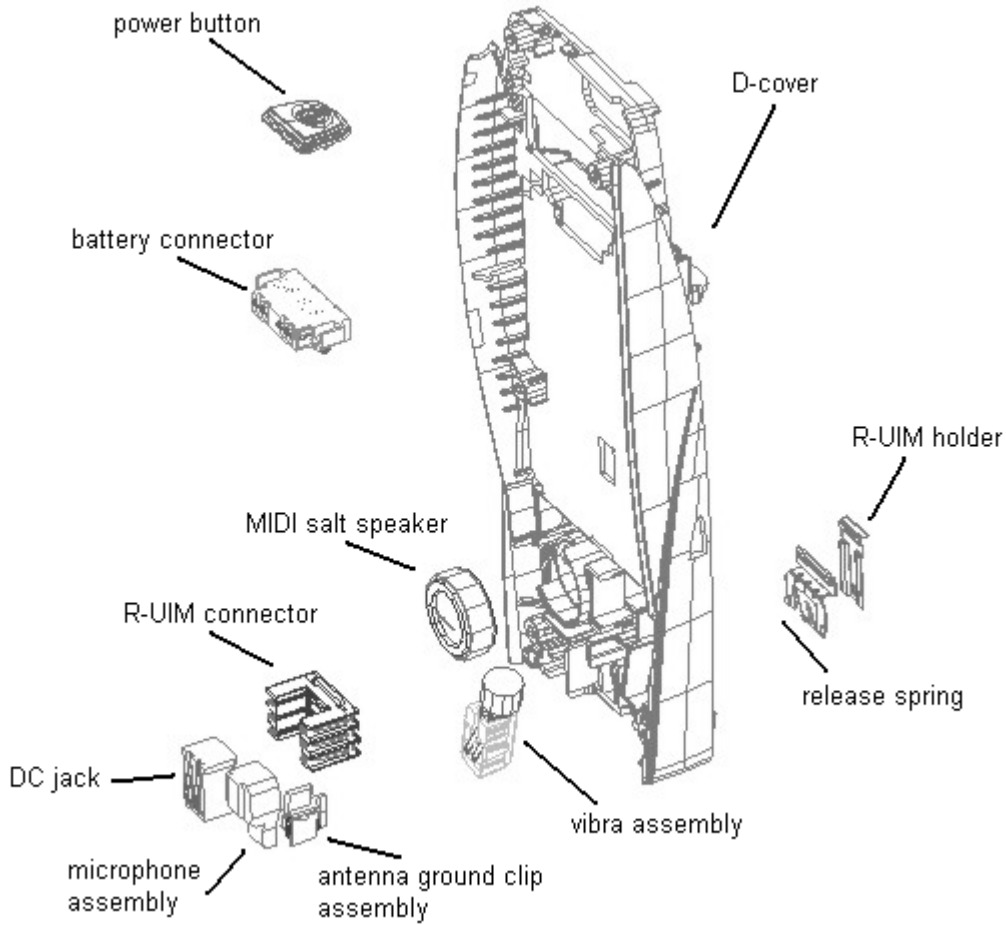

Product Code	Description
5140265	MIC MOD+HOLDER TOMAHAWK -42+-3DB
5140269	SALT SPEAKER ASSY DNS05681 HDBA2
5400169	SIM CONN 2X3POL P2.54 SPR 15V 1A
5400223	BATT CONN 4POLE SPR 200V 2A RA
5400243	CONN DC-JACK 3.5MM 3POL SPR 90DEG
5409601	ANTENNA GROUND CLIP DMC04770
6297701	SCREW 1.8 X 5 DELTA PT PAN HD TOR
6800049	VIB MOT. ASSY 1.3V 115MA 9500RPM
9452141	POWER BUTTON DMD08010 EAGLE
9452740	D-COVER DMD09866-EN BLANK HDDA2
9510927	RELEASE SPRING DMD08725
9510928	SIM CARD HOLDER DMD08726

Parts Lists

RH-44 (3586i) – EDMS Issue 4.0 Code: 0202159

Item	Code	Side	X	Y	Description	Value	Type
R001	1430788	Bottom	C	6	chip res 0W06	22K J	0402
R002	1430728	Bottom	H	7	chip res 0W06	120R J	0402
R003	1430700	Bottom	H	6	chip res 0W06	10R J	0402
R004	1430730	Bottom	H	6	chip res 0W06	150R J	0402
R052	1430804	Bottom	G	3	chip res 0W06	100K J	0402
R054	1430690	Bottom	H	3	chip res jumper	0R0	0402
R060	1430690	Bottom	F	4	chip res jumper	0R0	0402
R100	1620027	Bottom	W	4	res network 0W06	2x47R J	0404
R101	1620027	Bottom	W	5	res network 0W06	2x47R J	0404
R102	1620027	Bottom	W	6	res network 0W06	2x47R J	0404
R104	1430812	Bottom	W	5	chip res 0W06	220K J	0402
R110	1430804	Top	R	2	chip res 0W06	100K J	0402
R150	1430754	Top	R	7	chip res 0W06	1K0 J	0402
R151	1430754	Top	R	6	chip res 0W06	1K0 J	0402
R152	1430796	Top	R	6	chip res 0W06	47K J	0402
R153	1825033	Bottom	W	3	chip varistor VWM14V	VC46V	0402
R154	1825033	Bottom	W	3	chip varistor VWM14V	VC46V	0402
R155	1430754	Top	S	6	chip res 0W06	1K0 J	0402
R156	1430778	Top	R	6	chip res 0W06	10K J	0402
R158	1430778	Top	R	9	chip res 0W06	10K J	0402
R159	1430758	Top	S	7	chip res 0W06	1K5 J	0402
R160	1430710	Top	R	7	chip res 0W06	22R J	0402
R162	1430754	Top	S	6	chip res 0W06	1K0 J	0402
R164	1430754	Top	R	7	chip res 0W06	1K0 J	0402
R165	1430710	Top	R	8	chip res 0W06	22R J	0402
R166	1430796	Top	R	7	chip res 0W06	47K J	0402
R167	1430754	Top	R	7	chip res 0W06	1K0 J	0402
R169	1430718	Top	Q	8	chip res 0W06	47R J	0402
R171	1430754	Top	R	7	chip res 0W06	1K0 J	0402

Item	Code	Side	X	Y	Description	Value	Type
R172	1430796	Top	R	7	chip res 0W06	47K J	0402
R173	1430754	Top	R	7	chip res 0W06	1K0 J	0402
R176	1430754	Top	R	6	chip res 0W06	1K0 J	0402
R178	1430754	Top	R	7	chip res 0W06	1K0 J	0402
R179	1430804	Top	S	5	chip res 0W06	100K J	0402
R180	1430710	Top	R	8	chip res 0W06	22R J	0402
R181	1430710	Top	R	8	chip res 0W06	22R J	0402
R185	1430804	Top	R	9	chip res 0W06	100K J	0402
R195	1430796	Top	S	5	chip res 0W06	47K J	0402
R200	1419003	Top	O	8	chip res 0W5	0R22 J 200 ppm	1210
R202	1620043	Top	R	6	res network 0W03	4x100K J	0804
R203	1430770	Top	R	6	chip res 0W06	4K7 J	0402
R204	1430770	Top	R	6	chip res 0W06	4K7 J	0402
R302	1430770	Top	B	5	chip res 0W06	4K7 J	0402
R304	1825033	Top	R	5	chip varistor VWM14V	VC46V	0402
R305	1825033	Top	Q	8	chip varistor VWM14V	VC46V	0402
R307	1430726	Top	O	5	chip res 0W06	100R J	0402
R309	1430734	Top	T	5	chip res 0W06	220R J	0402
R310	1430734	Top	T	5	chip res 0W06	220R J	0402
R386	4120071	Top	T	4	ASIP EMIF03-SIM01	SIM filter	BGA8
R427	1430754	Top	S	3	chip res 0W06	1K0 J	0402
R428	1430770	Top	P	5	chip res 0W06	4K7 J	0402
R430	1430754	Top	S	4	chip res 0W06	1K0 J	0402
R431	1430770	Top	Q	5	chip res 0W06	4K7 J	0402
R433	1430754	Top	S	5	chip res 0W06	1K0 J	0402
R434	1430770	Top	S	5	chip res 0W06	4K7 J	0402
R435	1430770	Top	S	2	chip res 0W06	4K7 J	0402
R450	1430770	Top	O	4	chip res 0W06	4K7 J	0402
R501	1430700	Top	J	7	chip res 0W06	10R J	0402
R503	1430778	Top	K	7	chip res 0W06	10K J	0402
R505	1430700	Top	J	5	chip res 0W06	10R J	0402
R506	1430706	Top	J	5	chip res 0W06	15R J	0402

Item	Code	Side	X	Y	Description	Value	Type
R508	1430766	Top	K	9	chip res 0W06	3K9 J	0402
R509	1430726	Top	K	5	chip res 0W06	100R J	0402
R510	1430804	Top	L	8	chip res 0W06	100K J	0402
R511	1430794	Top	L	8	chip res 0W06	39K J	0402
R512	1430700	Top	L	9	chip res 0W06	10R J	0402
R513	1430700	Top	J	7	chip res 0W06	10R J	0402
R515	1430700	Top	J	7	chip res 0W06	10R J	0402
R517	1430772	Top	M	8	chip res 0W06	5K 6 J	0402
R518	1430740	Top	M	8	chip res 0W06	330R J	0402
R519	1430726	Top	K	5	chip res 0W06	100R J	0402
R520	1430754	Top	M	8	chip res 0W06	1K0 J	0402
R521	1430764	Top	M	8	chip res 0W06	3K3 J	0402
R522	1430728	Top	M	7	chip res 0W06	120R J	0402
R530	1430790	Top	K	5	chip res 0W06	27K J	0402
R550	1430778	Top	K	7	chip res 0W06	10K J	0402
R601	1430758	Top	M	3	chip res 0W06	1K5 J	0402
R602	1430790	Top	L	2	chip res 0W06	27K J	0402
R604	1430772	Top	K	3	chip res 0W06	5K 6 J	0402
R605	1430770	Top	M	4	chip res 0W06	4K7 J	0402
R606	1430770	Top	M	4	chip res 0W06	4K7 J	0402
R607	1430762	Top	M	4	chip res 0W06	2K2 J	0402
R609	1430758	Top	M	3	chip res 0W06	1K5 J	0402
R611	1430804	Top	M	2	chip res 0W06	100K J	0402
R613	1430690	Top	M	4	chip res jumper	0R0	0402
R621	1430774	Top	L	2	chip res 0W06	6K8 J	0402
R630	1430690	Top	L	2	chip res jumper	0R0	0402
R631	1430690	Top	L	2	chip res jumper	0R0	0402
R640	1430744	Top	L	4	chip res 0W06	470R J	0402
R641	1430744	Top	L	4	chip res 0W06	470R J	0402
R702	1430754	Top	L	5	chip res 0W06	1K0 J	0402
R703	1430744	Top	M	5	chip res 0W06	470R J	0402
R704	1430770	Top	L	5	chip res 0W06	4K7 J	0402

Item	Code	Side	X	Y	Description	Value	Type
R705	1430790	Top	M	6	chip res 0W06	27K J	0402
R706	1430776	Top	M	7	chip res 0W06	8K2 J	0402
R750	1430722	Top	D	7	chip res 0W06	68R J	0402
R751	1430690	Top	H	5	chip res jumper	0R0	0402
R764	1430796	Top	M	8	chip res 0W06	47K J	0402
R765	1430796	Top	M	8	chip res 0W06	47K J	0402
R768	1430796	Top	D	7	chip res 0W06	47K J	0402
R769	1430681	Top	C	7	chip res 0W06	4R3 J	0402
R801	1430744	Top	H	2	chip res 0W06	470R J	0402
R802	1430754	Top	H	3	chip res 0W06	1K0 J	0402
R803	1430744	Top	H	2	chip res 0W06	470R J	0402
R808	1820035	Top	I	3	NTC res 47K J	B=4050+-3%	0805
R812	1430804	Bottom	W	6	chip res 0W06	100K J	0402
R814	1430681	Top	C	7	chip res 0W06	4R3 J	0402
R904	1430744	Top	L	6	chip res 0W06	470R J	0402
C001	2320538	Top	C	8	chip cap NPO 12P J	50V	0402
C002	2320520	Top	C	8	chip cap NPO 2P2 C	50V	0402
C004	2320805	Bottom	H	7	chip cap X5R 100N K	10V	0402
C005	2320546	Bottom	H	7	chip cap NPO 27P J	50V	0402
C006	2320536	Bottom	G	6	chip cap NPO 10P J	50V	0402
C007	2320481	Bottom	H	6	chip cap X5R 1U K	6V3	0603
C008	2320552	Bottom	H	6	chip cap NPO 47P J	50V	0402
C009	2320532	Bottom	H	6	chip cap NPO 6P8 C	50V	0402
C012	2320522	Bottom	G	5	chip cap NPO 2P7 C	50V	0402
C014	2320540	Bottom	G	5	chip cap NPO 15P J	50V	0402
C015	2320778	Bottom	E	7	chip cap X7R 10N K	16V	0402
C017	2320544	Bottom	F	5	chip cap NPO 22P J	50V	0402
C018	2320805	Bottom	F	5	chip cap X5R 100N K	10V	0402
C019	2320620	Bottom	G	6	chip cap X7R 10N J	16V	0402
C020	2320620	Bottom	F	5	chip cap X7R 10N J	16V	0402
C021	2320620	Bottom	G	5	chip cap X7R 10N J	16V	0402
C023	2320544	Bottom	G	5	chip cap NPO 22P J	50V	0402

Item	Code	Side	X	Y	Description	Value	Type
C024	2320544	Bottom	F	5	chip cap NPO 22P J	50V	0402
C025	2320544	Bottom	G	5	chip cap NPO 22P J	50V	0402
C026	2320805	Bottom	G	5	chip cap X5R 100N K	10V	0402
C029	2320536	Bottom	F	6	chip cap NPO 10P J	50V	0402
C051	2320805	Bottom	F	3	chip cap X5R 100N K	10V	0402
C052	2320805	Bottom	F	4	chip cap X5R 100N K	10V	0402
C054	2320805	Bottom	H	4	chip cap X5R 100N K	10V	0402
C056	2320805	Bottom	H	3	chip cap X5R 100N K	10V	0402
C057	2320805	Bottom	H	4	chip cap X5R 100N K	10V	0402
C058	2320805	Bottom	F	3	chip cap X5R 100N K	10V	0402
C060	2320805	Bottom	F	4	chip cap X5R 100N K	10V	0402
C063	2316001	Bottom	H	5	chip cap X5R 2U2 K	6V3	0603
C064	2316001	Bottom	H	5	chip cap X5R 2U2 K	6V3	0603
C065	2320620	Bottom	H	5	chip cap X7R 10N J	16V	0402
C068	2320778	Top	O	5	chip cap X7R 10N K	16V	0402
C101	2320139	Bottom	W	6	chip cap X5R 1U0 K	10V	0603
C102	2320481	Bottom	W	7	chip cap X5R 1U K	6V3	0603
C103	2320544	Bottom	W	6	chip cap NPO 22P J	50V	0402
C104	2320544	Bottom	W	5	chip cap NPO 22P J	50V	0402
C105	2320544	Bottom	W	4	chip cap NPO 22P J	50V	0402
C106	2320744	Top	U	6	chip cap X7R 1N0 K	50V	0402
C107	2320778	Bottom	W	7	chip cap X7R 10N K	16V	0402
C108	2320550	Top	F	5	chip cap NPO 39P J	50V	0402
C109	2320536	Top	F	5	chip cap NPO 10P J	50V	0402
C110	2320550	Top	F	6	chip cap NPO 39P J	50V	0402
C111	2320550	Top	V	6	chip cap NPO 39P J	50V	0402
C151	2320552	Top	R	7	chip cap NPO 47P J	50V	0402
C153	2320552	Top	R	6	chip cap NPO 47P J	50V	0402
C154	2320805	Top	S	6	chip cap X5R 100N K	10V	0402
C155	2320805	Top	S	6	chip cap X5R 100N K	10V	0402
C157	2320143	Top	R	9	chip cap X5R 220N K	6.3V	0402
C159	2320552	Top	R	7	chip cap NPO 47P J	50V	0402

Item	Code	Side	X	Y	Description	Value	Type
C164	2320805	Top	R	8	chip cap X5R 100N K	10V	0402
C165	2320805	Top	S	7	chip cap X5R 100N K	10V	0402
C168	2320805	Top	S	7	chip cap X5R 100N K	10V	0402
C169	2320805	Top	S	6	chip cap X5R 100N K	10V	0402
C171	2320552	Top	R	7	chip cap NPO 47P J	50V	0402
C172	2320552	Top	R	9	chip cap NPO 47P J	50V	0402
C173	2320552	Top	R	7	chip cap NPO 47P J	50V	0402
C174	2320805	Top	S	7	chip cap X5R 100N K	10V	0402
C175	2320805	Top	S	7	chip cap X5R 100N K	10V	0402
C185	2320552	Top	R	7	chip cap NPO 47P J	50V	0402
C186	2312249	Top	R	8	chip cap X5R 4U7 K	10V	0805
C193	2320805	Top	R	6	chip cap X5R 100N K	10V	0402
C195	2320805	Top	R	6	chip cap X5R 100N K	10V	0402
C196	2318003	Top	R	8	chip cap X5R 1U0 K	16V	0805
C197	2320560	Top	R	8	chip cap NPO 100P J	50V	0402
C198	2318003	Top	R	8	chip cap X5R 1U0 K	16V	0805
C202	2320778	Top	O	8	chip cap X7R 10N K	16V	0402
C211	2320481	Top	Q	8	chip cap X5R 1U K	6V3	0603
C222	2320805	Top	O	5	chip cap X5R 100N K	10V	0402
C224	2320143	Top	O	8	chip cap X5R 220N K	6.3V	0402
C225	2320805	Top	O	5	chip cap X5R 100N K	10V	0402
C226	2320481	Top	P	8	chip cap X5R 1U K	6V3	0603
C227	2320778	Top	R	6	chip cap X7R 10N K	16V	0402
C229	2320805	Top	P	5	chip cap X5R 100N K	10V	0402
C230	2320778	Top	R	5	chip cap X7R 10N K	16V	0402
C232	2320778	Top	R	5	chip cap X7R 10N K	16V	0402
C233	2320481	Top	Q	6	chip cap X5R 1U K	6V3	0603
C234	2320481	Top	P	8	chip cap X5R 1U K	6V3	0603
C235	2320481	Top	Q	8	chip cap X5R 1U K	6V3	0603
C237	2320481	Top	P	8	chip cap X5R 1U K	6V3	0603
C238	2320805	Top	R	5	chip cap X5R 100N K	10V	0402
C239	2320481	Top	P	8	chip cap X5R 1U K	6V3	0603

Item	Code	Side	X	Y	Description	Value	Type
C240	2320481	Top	P	8	chip cap X5R 1U K	6V3	0603
C241	2320805	Top	O	8	chip cap X5R 100N K	10V	0402
C242	2320481	Top	Q	5	chip cap X5R 1U K	6V3	0603
C243	2320481	Top	Q	5	chip cap X5R 1U K	6V3	0603
C244	2320481	Top	Q	6	chip cap X5R 1U K	6V3	0603
C245	2320481	Top	P	8	chip cap X5R 1U K	6V3	0603
C246	2320481	Top	O	6	chip cap X5R 1U K	6V3	0603
C247	2320481	Top	O	6	chip cap X5R 1U K	6V3	0603
C248	2320481	Top	O	7	chip cap X5R 1U K	6V3	0603
C249	2320481	Top	O	6	chip cap X5R 1U K	6V3	0603
C250	2320481	Top	O	7	chip cap X5R 1U K	6V3	0603
C251	2320481	Top	O	7	chip cap X5R 1U K	6V3	0603
C252	2320481	Top	N	6	chip cap X5R 1U K	6V3	0603
C253	2320481	Top	N	7	chip cap X5R 1U K	6V3	0603
C254	2320481	Top	O	6	chip cap X5R 1U K	6V3	0603
C255	2320481	Top	N	6	chip cap X5R 1U K	6V3	0603
C256	2320481	Top	N	6	chip cap X5R 1U K	6V3	0603
C257	2320481	Top	N	6	chip cap X5R 1U K	6V3	0603
C258	2320481	Top	N	7	chip cap X5R 1U K	6V3	0603
C259	2320481	Top	N	7	chip cap X5R 1U K	6V3	0603
C260	2312255	Top	N	7	chip cap X5R 10U K	10V	1206
C264	2320481	Top	P	8	chip cap X5R 1U K	6V3	0603
C270	2312255	Top	O	2	chip cap X5R 10U K	10V	1206
C271	2312255	Top	R	2	chip cap X5R 10U K	10V	1206
C273	2320805	Top	P	2	chip cap X5R 100N K	10V	0402
C301	2320805	Bottom	E	5	chip cap X5R 100N K	10V	0402
C302	2320805	Bottom	E	5	chip cap X5R 100N K	10V	0402
C303	2320779	Bottom	E	5	chip cap X7R 100N K	16V	0603
C304	2320778	Top	B	5	chip cap X7R 10N K	16V	0402
C305	2320546	Top	R	6	chip cap NP0 27P J	50V	0402
C306	2320481	Top	N	5	chip cap X5R 1U K	6V3	0603
C307	2320481	Top	N	5	chip cap X5R 1U K	6V3	0603

Item	Code	Side	X	Y	Description	Value	Type
C308	2320481	Top	O	5	chip cap X5R 1U K	6V3	0603
C309	2320481	Top	O	5	chip cap X5R 1U K	6V3	0603
C311	2320550	Bottom	E	4	chip cap NPO 39P J	50V	0402
C312	2320550	Bottom	E	5	chip cap NPO 39P J	50V	0402
C389	2320481	Top	T	4	chip cap X5R 1U K	6V3	0603
C390	2320805	Top	U	4	chip cap X5R 100N K	10V	0402
C400	2320805	Top	S	3	chip cap X5R 100N K	10V	0402
C401	2320805	Top	R	5	chip cap X5R 100N K	10V	0402
C402	2320805	Top	P	4	chip cap X5R 100N K	10V	0402
C403	2320805	Top	Q	2	chip cap X5R 100N K	10V	0402
C404	2320805	Top	S	4	chip cap X5R 100N K	10V	0402
C405	2320805	Top	P	2	chip cap X5R 100N K	10V	0402
C422	2320620	Top	S	3	chip cap X7R 10N J	16V	0402
C423	2320744	Top	P	5	chip cap X7R 1N0 K	50V	0402
C424	2320620	Top	S	4	chip cap X7R 10N J	16V	0402
C425	2320744	Top	Q	5	chip cap X7R 1N0 K	50V	0402
C426	2320620	Top	R	5	chip cap X7R 10N J	16V	0402
C427	2320744	Top	S	5	chip cap X7R 1N0 K	50V	0402
C428	2320778	Top	S	3	chip cap X7R 10N K	16V	0402
C429	2320783	Top	R	5	chip cap X7R 33N K	10V	0402
C430	2320783	Top	P	5	chip cap X7R 33N K	10V	0402
C431	2320783	Top	Q	5	chip cap X7R 33N K	10V	0402
C435	2320778	Top	M	7	chip cap X7R 10N K	16V	0402
C450	2320778	Top	P	5	chip cap X7R 10N K	16V	0402
C451	2320805	Top	P	5	chip cap X5R 100N K	10V	0402
C454	2320778	Top	P	5	chip cap X7R 10N K	16V	0402
C501	2320552	Top	I	7	chip cap NPO 47P J	50V	0402
C502	2320576	Top	M	8	chip cap X7R 470P J	50V	0402
C503	2320783	Top	L	8	chip cap X7R 33N K	10V	0402
C504	2320620	Top	J	7	chip cap X7R 10N J	16V	0402
C505	2320620	Top	L	9	chip cap X7R 10N J	16V	0402
C507	2320620	Top	J	7	chip cap X7R 10N J	16V	0402

Item	Code	Side	X	Y	Description	Value	Type
C508	2420019	Top	K	8	chip cap PPS 68N J	16V	1210
C509	2320584	Top	K	7	chip cap X7R 1N0 J	50V	0402
C511	2320481	Top	I	8	chip cap X5R 1U K	6V3	0603
C512	2320576	Top	M	8	chip cap X7R 470P J	50V	0402
C513	2320576	Top	M	8	chip cap X7R 470P J	50V	0402
C514	2320550	Top	M	2	chip cap NPO 39P J	50V	0402
C515	2320552	Top	K	8	chip cap NPO 47P J	50V	0402
C516	2320548	Top	J	5	chip cap NPO 33P J	50V	0402
C517	2320576	Top	K	8	chip cap X7R 470P J	50V	0402
C518	2320618	Top	K	8	chip cap X7R 4N7 J	25V	0402
C519	2320522	Top	L	2	chip cap NPO 2P7 C	50V	0402
C520	2320481	Top	L	9	chip cap X5R 1U K	6V3	0603
C521	2320805	Top	J	7	chip cap X5R 100N K	10V	0402
C522	2320620	Top	J	7	chip cap X7R 10N J	16V	0402
C523	2320584	Top	M	8	chip cap X7R 1N0 J	50V	0402
C524	2320576	Top	P	4	chip cap X7R 470P J	50V	0402
C525	2320584	Top	M	7	chip cap X7R 1N0 J	50V	0402
C530	2320620	Top	K	5	chip cap X7R 10N J	16V	0402
C532	2320532	Top	I	7	chip cap NPO 6P8 C	50V	0402
C550	2320584	Top	K	7	chip cap X7R 1N0 J	50V	0402
C553	2320538	Top	L	1	chip cap NPO 12P J	50V	0402
C602	2320633	Top	M	3	chip cap NPO 220P J	25V	0402
C603	2320536	Top	M	2	chip cap NPO 10P J	50V	0402
C604	2320540	Top	I	4	chip cap NPO 15P J	50V	0402
C605	2320560	Top	L	4	chip cap NPO 100P J	50V	0402
C606	2320744	Top	M	3	chip cap X7R 1N0 K	50V	0402
C607	2320620	Top	M	2	chip cap X7R 10N J	16V	0402
C608	2320540	Top	J	3	chip cap NPO 15P J	50V	0402
C610	2320556	Top	I	2	chip cap NPO 68P J	50V	0402
C611	2320540	Top	K	4	chip cap NPO 15P J	50V	0402
C612	2320120	Top	M	4	chip cap X7R 22N K	25V	0603
C613	2360001	Top	M	4	chip cap X5R 330N K	10V	0603

Item	Code	Side	X	Y	Description	Value	Type
C614	2320536	Top	K	2	chip cap NPO 10P J	50V	0402
C615	2320744	Top	K	2	chip cap X7R 1N0 K	50V	0402
C617	2320520	Top	M	3	chip cap NPO 2P2 C	50V	0402
C618	2320481	Top	M	2	chip cap X5R 1U K	6V3	0603
C619	2320552	Top	K	1	chip cap NPO 47P J	50V	0402
C621	2320744	Top	K	5	chip cap X7R 1N0 K	50V	0402
C624	2320536	Top	L	4	chip cap NPO 10P J	50V	0402
C627	2320540	Top	J	4	chip cap NPO 15P J	50V	0402
C629	2320532	Top	M	3	chip cap NPO 6P8 C	50V	0402
C630	2320007	Top	M	4	chip cap NPO 16P J	50V	0402
C631	2320524	Top	M	4	chip cap NPO 3P3 C	50V	0402
C632	2320744	Top	M	4	chip cap X7R 1N0 K	50V	0402
C633	2320552	Top	K	4	chip cap NPO 47P J	50V	0402
C634	2320584	Top	L	5	chip cap X7R 1N0 J	50V	0402
C635	2320584	Top	K	4	chip cap X7R 1N0 J	50V	0402
C637	2320560	Top	M	3	chip cap NPO 100P J	50V	0402
C638	2320620	Top	M	4	chip cap X7R 10N J	16V	0402
C639	2320584	Top	L	1	chip cap X7R 1N0 J	50V	0402
C640	2320520	Top	K	3	chip cap NPO 2P2 C	50V	0402
C642	2320520	Top	K	3	chip cap NPO 2P2 C	50V	0402
C645	2320540	Top	J	3	chip cap NPO 15P J	50V	0402
C646	2320536	Top	L	4	chip cap NPO 10P J	50V	0402
C647	2320536	Top	L	4	chip cap NPO 10P J	50V	0402
C648	2320744	Top	K	1	chip cap X7R 1N0 K	50V	0402
C649	2320552	Top	K	2	chip cap NPO 47P J	50V	0402
C650	2320540	Top	I	3	chip cap NPO 15P J	50V	0402
C651	2320536	Top	K	4	chip cap NPO 10P J	50V	0402
C652	2320481	Top	M	5	chip cap X5R 1U K	6V3	0603
C653	2320744	Top	L	4	chip cap X7R 1N0 K	50V	0402
C660	2320536	Top	L	5	chip cap NPO 10P J	50V	0402
C666	2320552	Top	L	2	chip cap NPO 47P J	50V	0402
C701	2320783	Top	L	6	chip cap X7R 33N K	10V	0402

Item	Code	Side	X	Y	Description	Value	Type
C702	2320584	Top	L	6	chip cap X7R 1N0 J	50V	0402
C704	2320778	Top	M	7	chip cap X7R 10N K	16V	0402
C706	2320778	Top	M	6	chip cap X7R 10N K	16V	0402
C707	2320778	Top	M	7	chip cap X7R 10N K	16V	0402
C708	2320778	Top	L	6	chip cap X7R 10N K	16V	0402
C710	2320778	Top	L	6	chip cap X7R 10N K	16V	0402
C712	2320778	Top	L	6	chip cap X7R 10N K	16V	0402
C714	2360001	Top	M	6	chip cap X5R 330N K	10V	0603
C715	2320620	Top	M	5	chip cap X7R 10N J	16V	0402
C716	2320548	Top	L	5	chip cap NPO 33P J	50V	0402
C718	2320778	Top	M	7	chip cap X7R 10N K	16V	0402
C722	2320778	Top	L	7	chip cap X7R 10N K	16V	0402
C723	2320778	Top	M	7	chip cap X7R 10N K	16V	0402
C740	2320530	Top	D	7	chip cap NPO 5P6 C	50V	0402
C750	2320560	Top	D	7	chip cap NPO 100P J	50V	0402
C753	2320560	Top	D	7	chip cap NPO 100P J	50V	0402
C755	2320516	Top	B	5	chip cap NPO 1P5 C	50V	0402
C756	2320560	Top	D	7	chip cap NPO 100P J	50V	0402
C757	2320554	Top	C	5	chip cap NPO 56P J	50V	0402
C758	2320785	Top	C	5	chip cap X7R 47N K	10V	0402
C759	2320602	Top	D	5	chip cap NPO 4P7 C	50V	0402
C761	2320596	Top	H	5	chip cap X7R 3N3 J	50V	0402
C763	2320538	Top	C	7	chip cap NPO 12P J	50V	0402
C766	2320560	Top	C	5	chip cap NPO 100P J	50V	0402
C767	2320548	Top	I	5	chip cap NPO 33P J	50V	0402
C769	2320744	Top	D	7	chip cap X7R 1N0 K	50V	0402
C770	2320518	Top	H	8	chip cap NPO 1P8 C	50V	0402
C771	2320544	Top	L	7	chip cap NPO 22P J	50V	0402
C772	2320544	Top	L	7	chip cap NPO 22P J	50V	0402
C777	2320536	Top	H	8	chip cap NPO 10P J	50V	0402
C778	2320532	Top	H	8	chip cap NPO 6P8 C	50V	0402
C779	2320532	Top	H	9	chip cap NPO 6P8 C	50V	0402

Item	Code	Side	X	Y	Description	Value	Type
C781	2320526	Top	G	9	chip cap NPO 3P9 C	50V	0402
C782	2320516	Top	I	5	chip cap NPO 1P5 C	50V	0402
C783	2320602	Top	G	8	chip cap NPO 4P7 C	50V	0402
C784	2320584	Top	F	8	chip cap X7R 1N0 J	50V	0402
C785	2320508	Top	B	7	chip cap NPO 1P0 C	50V	0402
C786	2320805	Top	G	8	chip cap X5R 100N K	10V	0402
C787	2320538	Top	C	6	chip cap NPO 12P J	50V	0402
C788	2320807	Top	C	7	chip cap X5R 100N K	10V	0402
C807	2320778	Top	H	3	chip cap X7R 10N K	16V	0402
C808	2320584	Top	I	3	chip cap X7R 1N0 J	50V	0402
C809	2320540	Top	I	5	chip cap NPO 15P J	50V	0402
C810	2320584	Top	H	3	chip cap X7R 1N0 J	50V	0402
C811	2320556	Top	I	2	chip cap NPO 68P J	50V	0402
C813	2320552	Top	I	3	chip cap NPO 47P J	50V	0402
C814	2320560	Top	H	5	chip cap NPO 100P J	50V	0402
C817	2312255	Top	I	3	chip cap X5R 10U K	10V	1206
C907	2320556	Top	K	2	chip cap NPO 68P J	50V	0402
L002	3646065	Top	C	8	chip coil 12N J	Q31/800MHz	0402
L003	3646051	Bottom	G	7	chip coil 3N9 +-0N3	Q28/800M	0402
L005	3646061	Bottom	G	7	chip coil 15N J	Q30/800MHz	0402
L006	3646051	Bottom	H	6	chip coil 3N9 +-0N3	Q28/800M	0402
L008	3646091	Bottom	G	5	chip coil 6N8 J	Q27/800MHz	0402
L100	3203743	Top	V	6	ferrite bead 0R03	42R/100MHz 3A	0805
L103	3203801	Bottom	W	3	chip bead array	2x10000R	0405
L120	3203801	Top	Q	7	chip bead array	2x10000R	0405
L121	3203801	Top	Q	7	chip bead array	2x10000R	0405
L122	3203801	Top	Q	7	chip bead array	2x10000R	0405
L270	3203723	Top	P	2	ferrite bead 0R35	68R/100MHz	0603
L271	3640091	Top	R	2	chip coil 15UH K 0.8A	6.5x5.3x2.0	
L501	3646007	Top	M	2	chip coil 27N J	Q27/800MHz	0402
L507	3646043	Top	J	5	chip coil 1N5 +-0N3	Q33/800M	0402
L603	3646015	Top	K	3	chip coil 8N2 J	Q7/100MHz	0402

Item	Code	Side	X	Y	Description	Value	Type
L604	3646015	Top	K	4	chip coil 8N2 J	Q7/100MHz	0402
L609	3646009	Top	L	4	chip coil 10N J	Q30/800MHz	0402
L610	3646009	Top	K	4	chip coil 10N J	Q30/800MHz	0402
L611	3645219	Top	M	4	chip coil 10N J	Q31/250MHz	0603
L666	3646001	Top	L	4	chip coil 3N3 +-0N3	Q7/100M	0402
L667	3646045	Top	L	5	chip coil 1N8 +-0N3	Q8/100M	0402
L701	3645223	Top	L	6	chip coil 33N J	Q40/250MHz	0603
L750	3646415	Top	B	6	chip coil 19N J	Q24/250MHz	0402
L751	3646405	Top	B	6	chip coil 6N2 J	Q20/250MHz	0402
L752	3646019	Top	C	5	chip coil 15N J	Q7/100MHz	0402
L753	3645351	Top	C	5	chip coil 220N J	Q8/50MHz	0603
L754	3645195	Top	H	5	chip coil 82N J	Q12/100MHz	0603
L755	3646019	Top	C	6	chip coil 15N J	Q7/100MHz	0402
L757	3646019	Top	C	5	chip coil 15N J	Q7/100MHz	0402
L759	3645243	Top	H	8	chip coil 47N J	Q38/200MHz	0603
L760	3645229	Top	L	7	chip coil 120N J	Q32/150MHz	0603
L761	3645229	Top	L	7	chip coil 120N J	Q32/150MHz	0603
L762	3645195	Top	G	8	chip coil 82N J	Q12/100MHz	0603
L764	3645301	Top	G	8	chip coil 180N J	Q13/100MHz	0603
L765	3645229	Top	H	8	chip coil 120N J	Q32/150MHz	0603
L766	3645229	Top	H	9	chip coil 120N J	Q32/150MHz	0603
L767	3645319	Top	I	8	chip coil 220N J	Q25/100MHz	0603
L768	3645319	Top	I	9	chip coil 220N J	Q25/100MHz	0603
L769	3646065	Top	D	7	chip coil 12N J	Q31/800MHz	0402
L770	3645195	Top	D	5	chip coil 82N J	Q12/100MHz	0603
L771	3646011	Top	D	6	chip coil 4N7 +-0N3	Q7/100M	0402
L773	3646099	Top	C	7	chip coil 2N7 +-0N3	Q29/800M	0402
L801	3645191	Top	G	3	chip coil 8N2 J	Q10/100MHz	0603
L802	3646039	Top	H	3	chip coil 5N6 +-0N3	Q7/100M	0402
L805	3646421	Top	V	2	chip coil 1N0 K	Q16/250MHz	0402
V001	4210189	Bottom	H	6	TR BFP620 N2.5V 70GHz	F=0.7	SOT343
V100	4113721	Top	V	6	tvS di 1PMT16AT3	16V 175W	PWRMITE

Item	Code	Side	X	Y	Description	Value	Type
V101	4120011	Bottom	W	5	zdix4 IP4043CX5 CA	14V2 10W	CSP5
V152	4120061	Bottom	W	4	ASIP 2-lines EMI/ESD	filter	BGA6
V153	4120061	Top	B	8	ASIP 2-lines EMI/ESD	filter	BGA6
V154	4120011	Top	Q	8	zdix4 IP4043CX5 CA	14V2 10W	CSP5
V270	4110441	Top	Q	2	sch di STPS0520Z	20V 0.5A	SOD123
V303	4860451	Bottom	L	4	LED CL510 White		600MCD
V304	4860451	Bottom	L	2	LED CL510 White		600MCD
V305	4860451	Bottom	L	6	LED CL510 White		600MCD
V306	4860451	Bottom	L	8	LED CL510 White		600MCD
V309	4864543	Bottom	V	4	LED CL270WB-D White	90' VF < 4.0V	
V310	4864543	Bottom	V	6	LED CL270WB-D White	90' VF < 4.0V	
V420	4219921	Top	R	5	TR DTC143ZE N RBE4K7	47K 0A1	SC75
V421	4219921	Top	P	5	TR DTC143ZE N RBE4K7	47K 0A1	SC75
V422	4219921	Top	Q	5	TR DTC143ZE N RBE4K7	47K 0A1	SC75
V500	4210100	Top	M	8	TR BC848W N 30V	0.1A 100MHz	SOT323
V601	4110921	Top	M	5	cap di BBY57-02W	1/4 16/4P	SOD523
V602	4112491	Top	M	3	pin di BA892 0A1	0R7@1MA	SCD-80
V701	4110921	Top	L	5	cap di BBY57-02W	1/4 16/4P	SOD523
Z001	4550243	Top	F	9	Cer filt 1575.42+-2MHz		4x4x2
Z002	4510367	Bottom	G	6	Saw filt 1575+-2MHz	2DB	2.6x2.1x1
Z300	4120031	Top	T	5	EMI/ESD filt EMIF10-	1K010F1	BGA24
Z601	4511331	Top	J	4	Dual saw filt 1867/1892	+/-17.5MHz	
Z604	4511275	Top	J	2	Saw filt 836.5+-12.5MHz	3.5DB	3x3
Z750	4511295	Top	C	7	Saw filt 1960.0MHz	3.7DB	3x3x1
Z751	4511309	Top	C	5	Saw filt 881.5+-12.5MHz	3DB	2.5x2
Z752	4510359	Top	G	8	XTAL filt 128.1MHz+-	15KHz	3.8x3.8
Z753	4511329	Top	H	7	Saw filt 128.1+-	0.61MHz	9x5x1.6
Z801	4510361	Top	G	3	Isolator 1880+-30MHz	15DB	4x4x2
Z802	4510381	Top	G	2	Isolator 836+-12.5	13DB	5x5x2.0
Z803	4512175	Top	F	2	Dupl 824-849/869-	894MHz	5x5x1.5
Z804	4512159	Top	E	5	Dupl 1850-1910/1930-	1990MHz	24x7

Item	Code	Side	X	Y	Description	Value	Type
Z805	4550117	Top	C	4	Dipl 824-894/1850-	1990MHz	3.2x1.6
N001	4370953	Bottom	F	5	GPS RX TRF5101	PG2.1	PBGA-49
N052	4341269	Bottom	H	5	VREG 2.8V/150MA	(LP3985)	USMD5
N100	4341269	Bottom	W	6	VREG 2.8V/150MA	(LP3985)	USMD5
N150	4341221	Top	R	8	AF AMP 0.4W/2.6V	(LM4890)	USMD9
N270	4341255	Top	P	1	VREG PWM/LDO	(NCP1500)	MSOP8
N502	4341295	Top	L	1	RF AMP G5.5DB/2.1GHz	(ULOBA)	SC70-6
N601	4370857	Top	L	3	Robind SSBUP-con- verter	CDMA	TFBGA
N602	4370887	Top	K	4	Hornet RF2357E7	PCS driver amp	
N603	4370885	Top	K	1	Tomcat RF2356E4	CDMA 2000	SOT23-8
N701	4370851	Top	L	7	Batmand RFIC RCVR	CDMA	UFBGA84
N750	4370863	Top	C	6	Alfred LNA/Mixer/		VQFN-24
N801	4350419	Top	I	2	pw amp CX77134-16		CDMA2000
N802	4350395	Top	H	4	pw amp 1850-1910M		SNAPPER
N805	4341413	Top	J	3	SW SPDT DC-3.0GHz	(CSH210R)	SC70-6
N806	4120091	Top	H	3	ASIP STPAC01-F1	CDMA pwr det	BGA8
N807	4341395	Top[J	8	1XPLL/SYNTH 2.5GHz	(LMX2310U)	MLF20
D051	4370947	Bottom	G	4	TWL5001 GPS BB ASIC		UBGA143
D200	4370825	Top	P	6	UEMK W-DOG ENA T021		TFBGA168
D400	4370873	Top	Q	3	UPP8M V2.2 F751986B	C035	UBGA144
D450	4341441	Top	O	3	Combo 64M NOR+4M	SRAM	TBGA48
D451	4341397	Top	N	5	White LED driver	(LM2795BLX)	USMD14
G501	4510347	Top	L	8	VCTCXO 19.2MHz+-	1.5ppm	2.7V
G502	4350329	Top	J	6	VCO 986-1034/2040-	2140MHz	2.7V
B002	4510403	Bottom	E	8	TCXO 16.368MHz+-	15ppm 2.8V	GPS
B200	4510303	Top	Q	8	Crystal 32.768KHz+-	20ppm	12.5PF
T603	4550211	Top	L	4	Transf balun 1850- 1990MHz		SMD
T604	4550209	Top	K	3	Transf balun 824- 894MHz		SMD
F100	5119019	Top	V	6	Sm fuse F	1.5A 32V	0603
S301	5209001	Top	A	6	Sm SW tact SPST	12V 50MA	Side Key
X001	5429021	Top	E	8	Sm Conn RF+SW	100V 1W 50R	2.2GHz

Item	Code	Side	X	Y	Description	Value	Type
X002	9510434	Top	C	8	Spring clip M3E14601	NSJ-3	HD925
X003	9510434	Top	D	8	Spring clip M3E14601	NSJ-3	HD925
X101	5460061	Top	W	4	Sm system connector		14POL
X814	5429021	Bottom	B	2	Sm Conn RF+SW	100V 1W 50R	2.2GHz
A101	9517250	Top	C	6	LNA can assy	DMC05933	0.20MM
A102	9510686	Top	E	5	Duplexer shield	DMD07064	HDAA3
A103	9517249	Top	K	7	Can assy RX	DMC05934	0.20MM
A104	9517154	Top	I	3	RF can assy TX	DMC04293	HDBA2
A105	9517156	Top	P	5	BB can assy	DMC04292	HDBA2
A201	9517212	Bottom	G	5	GPS can assy	DMC05432	HDDA2

RH-44 (3586) – EDMS Issue 4.0 Code: 0202160

Item	Code	Side	X	Y	Description	Value	Type
R100	1620027	Bottom	W	4	res network 0W06	2x47R J	0404
R101	1620027	Bottom	W	5	res network 0W06	2x47R J	0404
R102	1620027	Bottom	W	6	res network 0W06	2x47R J	0404
R104	1430812	Bottom	W	5	chip res 0W06	220K J	0402
R110	1430804	Top	R	2	chip res 0W06	100K J	0402
R150	1430754	Top	R	7	chip res 0W06	1K0 J	0402
R151	1430754	Top	R	6	chip res 0W06	1K0 J	0402
R152	1430796	Top	R	6	chip res 0W06	47K J	0402
R153	1825033	Bottom	W	3	chip varistor VWM14V	VC46V	0402
R154	1825033	Bottom	W	3	chip varistor VWM14V	VC46V	0402
R155	1430754	Top	S	6	chip res 0W06	1K0 J	0402
R156	1430778	Top	R	6	chip res 0W06	10K J	0402
R158	1430778	Top	R	9	chip res 0W06	10K J	0402
R159	1430758	Top	S	7	chip res 0W06	1K5 J	0402
R160	1430710	Top	R	7	chip res 0W06	22R J	0402
R162	1430754	Top	S	6	chip res 0W06	1K0 J	0402
R164	1430754	Top	R	7	chip res 0W06	1K0 J	0402
R165	1430710	Top	R	8	chip res 0W06	22R J	0402
R166	1430796	Top	R	7	chip res 0W06	47K J	0402
R167	1430754	Top	R	7	chip res 0W06	1K0 J	0402
R169	1430718	Top	Q	8	chip res 0W06	47R J	0402
R171	1430754	Top	R	7	chip res 0W06	1K0 J	0402
R172	1430796	Top	R	7	chip res 0W06	47K J	0402
R173	1430754	Top	R	7	chip res 0W06	1K0 J	0402
R176	1430754	Top	R	6	chip res 0W06	1K0 J	0402
R178	1430754	Top	R	7	chip res 0W06	1K0 J	0402
R179	1430804	Top	S	5	chip res 0W06	100K J	0402
R180	1430710	Top	R	8	chip res 0W06	22R J	0402
R181	1430710	Top	R	8	chip res 0W06	22R J	0402
R185	1430804	Top	R	9	chip res 0W06	100K J	0402
R195	1430796	Top	S	5	chip res 0W06	47K J	0402

Item	Code	Side	X	Y	Description	Value	Type
R200	1419003	Top	O	8	chip res 0W05	0R22 J 200 ppm	1210
R202	1620043	Top	R	6	res network 0W03	4x100K J	0804
R203	1430770	Top	R	6	chip res 0W06	4K7 J	0402
R204	1430770	Top	R	6	chip res 0W06	4K7 J	0402
R302	1430770	Top	B	5	chip res 0W06	4K7 J	0402
R304	1825033	Top	R	5	chip varistor VWM14V	VC46V	0402
R305	1825033	Top	Q	8	chip varistor VWM14V	VC46V	0402
R307	1430726	Top	O	5	chip res 0W06	100R J	0402
R309	1430734	Top	T	5	chip res 0W06	220R J	0402
R310	1430734	Top	T	5	chip res 0W06	220R J	0402
R386	4120071	Top	T	4	ASIP EMIF03-SIM01	SIM filter	BGA8
R427	1430754	Top	S	3	chip res 0W06	1K0 J	0402
R428	1430770	Top	P	5	chip res 0W06	4K7 J	0402
R430	1430754	Top	S	4	chip res 0W06	1K0 J	0402
R431	1430770	Top	Q	5	chip res 0W06	4K7 J	0402
R433	1430754	Top	S	5	chip res 0W06	1K0 J	0402
R434	1430770	Top	S	5	chip res 0W06	4K7 J	0402
R435	1430770	Top	S	2	chip res 0W06	4K7 J	0402
R450	1430770	Top	O	4	chip res 0W06	4K7 J	0402
R501	1430700	Top	J	7	chip res 0W06	10R J	0402
R503	1430778	Top	K	7	chip res 0W06	10K J	0402
R505	1430700	Top	J	5	chip res 0W06	10R J	0402
R506	1430706	Top	J	5	chip res 0W06	15R J	0402
R508	1430766	Top	K	9	chip res 0W06	3K9 J	0402
R509	1430726	Top	K	5	chip res 0W06	100R J	0402
R510	1430804	Top	L	8	chip res 0W06	100K J	0402
R511	1430794	Top	L	8	chip res 0W06	39K J	0402
R512	1430700	Top	L	9	chip res 0W06	10R J	0402
R513	1430700	Top	J	7	chip res 0W06	10R J	0402
R515	1430700	Top	J	7	chip res 0W06	10R J	0402
R517	1430772	Top	M	8	chip res 0W06	5K 6 J	0402
R518	1430740	Top	M	8	chip res 0W06	330R J	0402

Item	Code	Side	X	Y	Description	Value	Type
R519	1430726	Top	K	5	chip res 0W06	100R J	0402
R520	1430754	Top	M	8	chip res 0W06	1K0 J	0402
R521	1430764	Top	M	8	chip res 0W06	3K3 J	0402
R522	1430728	Top	M	7	chip res 0W06	120R J	0402
R530	1430790	Top	K	5	chip res 0W06	27K J	0402
R550	1430778	Top	K	7	chip res 0W06	10K J	0402
R601	1430758	Top	M	3	chip res 0W06	1K5 J	0402
R602	1430790	Top	L	2	chip res 0W06	27K J	0402
R604	1430772	Top	K	3	chip res 0W06	5K 6 J	0402
R605	1430770	Top	M	4	chip res 0W06	4K7 J	0402
R606	1430770	Top	M	4	chip res 0W06	4K7 J	0402
R607	1430762	Top	M	4	chip res 0W06	2K2 J	0402
R609	1430758	Top	M	3	chip res 0W06	1K5 J	0402
R611	1430804	Top	M	2	chip res 0W06	100K J	0402
R613	1430690	Top	M	4	chip res jumper	0R0	0402
R621	1430774	Top	L	2	chip res 0W06	6K8 J	0402
R630	1430690	Top	L	2	chip res jumper	0R0	0402
R631	1430690	Top	L	2	chip res jumper	0R0	0402
R640	1430744	Top	L	4	chip res 0W06	470R J	0402
R641	1430744	Top	L	4	chip res 0W06	470R J	0402
R702	1430754	Top	L	5	chip res 0W06	1K0 J	0402
R703	1430744	Top	M	5	chip res 0W06	470R J	0402
R704	1430770	Top	L	5	chip res 0W06	4K7 J	0402
R705	1430790	Top	M	6	chip res 0W06	27K J	0402
R706	1430776	Top	M	7	chip res 0W06	8K2 J	0402
R750	1430722	Top	D	7	chip res 0W06	68R J	0402
R751	1430690	Top	H	5	chip res jumper	0R0	0402
R764	1430796	Top	M	8	chip res 0W06	47K J	0402
R765	1430796	Top	M	8	chip res 0W06	47K J	0402
R768	1430796	Top	D	7	chip res 0W06	47K J	0402
R769	1430681	Top	C	7	chip res 0W06	4R3 J	0402
R801	1430744	Top	H	2	chip res 0W06	470R J	0402

Item	Code	Side	X	Y	Description	Value	Type
R802	1430754	Top	H	3	chip res 0W06	1K0 J	0402
R803	1430744	Top	H	2	chip res 0W06	470R J	0402
R808	1820035	Top	I	3	NTC res 47K J	B=4050+-3%	0805
R812	1430804	Bottom	W	6	chip res 0W06	100K J	0402
R814	1430681	Top	C	7	chip res 0W06	4R3 J	0402
R904	1430744	Top	L	6	chip res 0W06	470R J	0402
C101	2320139	Bottom	W	6	chip cap X5R 1U0 K	10V	0603
C102	2320481	Bottom	W	7	chip cap X5R 1U K	6V3	0603
C103	2320544	Bottom	W	6	chip cap NPO 22P J	50V	0402
C104	2320544	Bottom	W	5	chip cap NPO 22P J	50V	0402
C105	2320544	Bottom	W	4	chip cap NPO 22P J	50V	0402
C106	2320744	Top	U	6	chip cap X7R 1N0 K	50V	0402
C107	2320778	Bottom	W	7	chip cap X7R 10N K	16V	0402
C108	2320550	Top	F	5	chip cap NPO 39P J	50V	0402
C109	2320536	Top	F	5	chip cap NPO 10P J	50V	0402
C110	2320550	Top	F	6	chip cap NPO 39P J	50V	0402
C111	2320550	Top	V	6	chip cap NPO 39P J	50V	0402
C151	2320552	Top	R	7	chip cap NPO 47P J	50V	0402
C153	2320552	Top	R	6	chip cap NPO 47P J	50V	0402
C154	2320805	Top	S	6	chip cap X5R 100N K	10V	0402
C155	2320805	Top	S	6	chip cap X5R 100N K	10V	0402
C157	2320143	Top	R	9	chip cap X5R 220N K	6.3V	0402
C159	2320552	Top	R	7	chip cap NPO 47P J	50V	0402
C164	2320805	Top	R	8	chip cap X5R 100N K	10V	0402
C165	2320805	Top	S	7	chip cap X5R 100N K	10V	0402
C168	2320805	Top	S	7	chip cap X5R 100N K	10V	0402
C169	2320805	Top	S	6	chip cap X5R 100N K	10V	0402
C171	2320552	Top	R	7	chip cap NPO 47P J	50V	0402
C172	2320552	Top	R	9	chip cap NPO 47P J	50V	0402
C173	2320552	Top	R	7	chip cap NPO 47P J	50V	0402
C174	2320805	Top	S	7	chip cap X5R 100N K	10V	0402
C175	2320805	Top	S	7	chip cap X5R 100N K	10V	0402

Item	Code	Side	X	Y	Description	Value	Type
C185	2320552	Top	R	7	chip cap NPO 47P J	50V	0402
C186	2312249	Top	R	8	chip cap X5R 4U7 K	10V	0805
C193	2320805	Top	R	6	chip cap X5R 100N K	10V	0402
C195	2320805	Top	R	6	chip cap X5R 100N K	10V	0402
C196	2318003	Top	R	8	chip cap X5R 1U0 K	16V	0805
C197	2320560	Top	R	8	chip cap NPO 100P J	50V	0402
C198	2318003	Top	R	8	chip cap X5R 1U0 K	16V	0805
C202	2320778	Top	O	8	chip cap X7R 10N K	16V	0402
C211	2320481	Top	Q	8	chip cap X5R 1U K	6V3	0603
C222	2320805	Top	O	5	chip cap X5R 100N K	10V	0402
C224	2320143	Top	O	8	chip cap X5R 220N K	6.3V	0402
C225	2320805	Top	O	5	chip cap X5R 100N K	10V	0402
C226	2320481	Top	P	8	chip cap X5R 1U K	6V3	0603
C227	2320778	Top	R	6	chip cap X7R 10N K	16V	0402
C229	2320805	Top	P	5	chip cap X5R 100N K	10V	0402
C230	2320778	Top	R	5	chip cap X7R 10N K	16V	0402
C232	2320778	Top	R	5	chip cap X7R 10N K	16V	0402
C233	2320481	Top	Q	6	chip cap X5R 1U K	6V3	0603
C234	2320481	Top	P	8	chip cap X5R 1U K	6V3	0603
C235	2320481	Top	Q	8	chip cap X5R 1U K	6V3	0603
C237	2320481	Top	P	8	chip cap X5R 1U K	6V3	0603
C238	2320805	Top	R	5	chip cap X5R 100N K	10V	0402
C239	2320481	Top	P	8	chip cap X5R 1U K	6V3	0603
C240	2320481	Top	P	8	chip cap X5R 1U K	6V3	0603
C241	2320805	Top	O	8	chip cap X5R 100N K	10V	0402
C242	2320481	Top	Q	5	chip cap X5R 1U K	6V3	0603
C243	2320481	Top	Q	5	chip cap X5R 1U K	6V3	0603
C244	2320481	Top	Q	6	chip cap X5R 1U K	6V3	0603
C245	2320481	Top	P	8	chip cap X5R 1U K	6V3	0603
C246	2320481	Top	O	6	chip cap X5R 1U K	6V3	0603
C247	2320481	Top	O	6	chip cap X5R 1U K	6V3	0603
C248	2320481	Top	O	7	chip cap X5R 1U K	6V3	0603

Item	Code	Side	X	Y	Description	Value	Type
C249	2320481	Top	O	6	chip cap X5R 1U K	6V3	0603
C250	2320481	Top	O	7	chip cap X5R 1U K	6V3	0603
C251	2320481	Top	O	7	chip cap X5R 1U K	6V3	0603
C252	2320481	Top	N	6	chip cap X5R 1U K	6V3	0603
C253	2320481	Top	N	7	chip cap X5R 1U K	6V3	0603
C254	2320481	Top	O	6	chip cap X5R 1U K	6V3	0603
C255	2320481	Top	N	6	chip cap X5R 1U K	6V3	0603
C256	2320481	Top	N	6	chip cap X5R 1U K	6V3	0603
C257	2320481	Top	N	6	chip cap X5R 1U K	6V3	0603
C258	2320481	Top	N	7	chip cap X5R 1U K	6V3	0603
C259	2320481	Top	N	7	chip cap X5R 1U K	6V3	0603
C260	2312255	Top	N	7	chip cap X5R 10U K	10V	1206
C264	2320481	Top	P	8	chip cap X5R 1U K	6V3	0603
C270	2312255	Top	O	2	chip cap X5R 10U K	10V	1206
C271	2312255	Top	R	2	chip cap X5R 10U K	10V	1206
C273	2320805	Top	P	2	chip cap X5R 100N K	10V	0402
C301	2320805	Bottom	E	5	chip cap X5R 100N K	10V	0402
C302	2320805	Bottom	E	5	chip cap X5R 100N K	10V	0402
C303	2320779	Bottom	E	5	chip cap X7R 100N K	16V	0603
C304	2320778	Top	B	5	chip cap X7R 10N K	16V	0402
C305	2320546	Top	R	6	chip cap NP0 27P J	50V	0402
C306	2320481	Top	N	5	chip cap X5R 1U K	6V3	0603
C307	2320481	Top	N	5	chip cap X5R 1U K	6V3	0603
C308	2320481	Top	O	5	chip cap X5R 1U K	6V3	0603
C309	2320481	Top	O	5	chip cap X5R 1U K	6V3	0603
C311	2320550	Bottom	E	4	chip cap NP0 39P J	50V	0402
C312	2320550	Bottom	E	5	chip cap NP0 39P J	50V	0402
C389	2320481	Top	T	4	chip cap X5R 1U K	6V3	0603
C390	2320805	Top	U	4	chip cap X5R 100N K	10V	0402
C400	2320805	Top	S	3	chip cap X5R 100N K	10V	0402
C401	2320805	Top	R	5	chip cap X5R 100N K	10V	0402
C402	2320805	Top	P	4	chip cap X5R 100N K	10V	0402

Item	Code	Side	X	Y	Description	Value	Type
C403	2320805	Top	Q	2	chip cap X5R 100N K	10V	0402
C404	2320805	Top	S	4	chip cap X5R 100N K	10V	0402
C405	2320805	Top	P	2	chip cap X5R 100N K	10V	0402
C422	2320620	Top	S	3	chip cap X7R 10N J	16V	0402
C423	2320744	Top	P	5	chip cap X7R 1N0 K	50V	0402
C424	2320620	Top	S	4	chip cap X7R 10N J	16V	0402
C425	2320744	Top	Q	5	chip cap X7R 1N0 K	50V	0402
C426	2320620	Top	R	5	chip cap X7R 10N J	16V	0402
C427	2320744	Top	S	5	chip cap X7R 1N0 K	50V	0402
C428	2320778	Top	S	3	chip cap X7R 10N K	16V	0402
C429	2320783	Top	R	5	chip cap X7R 33N K	10V	0402
C430	2320783	Top	P	5	chip cap X7R 33N K	10V	0402
C431	2320783	Top	Q	5	chip cap X7R 33N K	10V	0402
C435	2320778	Top	M	7	chip cap X7R 10N K	16V	0402
C450	2320778	Top	P	5	chip cap X7R 10N K	16V	0402
C451	2320805	Top	P	5	chip cap X5R 100N K	10V	0402
C454	2320778	Top	P	5	chip cap X7R 10N K	16V	0402
C501	2320552	Top	I	7	chip cap NPO 47P J	50V	0402
C502	2320576	Top	M	8	chip cap X7R 470P J	50V	0402
C503	2320783	Top	L	8	chip cap X7R 33N K	10V	0402
C504	2320620	Top	J	7	chip cap X7R 10N J	16V	0402
C505	2320620	Top	L	9	chip cap X7R 10N J	16V	0402
C507	2320620	Top	J	7	chip cap X7R 10N J	16V	0402
C508	2420019	Top	K	8	chip cap PPS 68N J	16V	1210
C509	2320584	Top	K	7	chip cap X7R 1N0 J	50V	0402
C511	2320481	Top	I	8	chip cap X5R 1U K	6V3	0603
C512	2320576	Top	M	8	chip cap X7R 470P J	50V	0402
C513	2320576	Top	M	8	chip cap X7R 470P J	50V	0402
C514	2320550	Top	M	2	chip cap NPO 39P J	50V	0402
C515	2320552	Top	K	8	chip cap NPO 47P J	50V	0402
C516	2320548	Top	J	5	chip cap NPO 33P J	50V	0402
C517	2320576	Top	K	8	chip cap X7R 470P J	50V	0402

Item	Code	Side	X	Y	Description	Value	Type
C518	2320618	Top	K	8	chip cap X7R 4N7 J	25V	0402
C519	2320522	Top	L	2	chip cap NPO 2P7 C	50V	0402
C520	2320481	Top	L	9	chip cap X5R 1U K	6V3	0603
C521	2320805	Top	J	7	chip cap X5R 100N K	10V	0402
C522	2320620	Top	J	7	chip cap X7R 10N J	16V	0402
C523	2320584	Top	M	8	chip cap X7R 1N0 J	50V	0402
C524	2320576	Top	P	4	chip cap X7R 470P J	50V	0402
C525	2320584	Top	M	7	chip cap X7R 1N0 J	50V	0402
C530	2320620	Top	K	5	chip cap X7R 10N J	16V	0402
C532	2320532	Top	I	7	chip cap NPO 6P8 C	50V	0402
C550	2320584	Top	K	7	chip cap X7R 1N0 J	50V	0402
C553	2320538	Top	L	1	chip cap NPO 12P J	50V	0402
C602	2320633	Top	M	3	chip cap NPO 220P J	25V	0402
C603	2320536	Top	M	2	chip cap NPO 10P J	50V	0402
C604	2320540	Top	I	4	chip cap NPO 15P J	50V	0402
C605	2320560	Top	L	4	chip cap NPO 100P J	50V	0402
C606	2320744	Top	M	3	chip cap X7R 1N0 K	50V	0402
C607	2320620	Top	M	2	chip cap X7R 10N J	16V	0402
C608	2320540	Top	J	3	chip cap NPO 15P J	50V	0402
C610	2320556	Top	I	2	chip cap NPO 68P J	50V	0402
C611	2320540	Top	K	4	chip cap NPO 15P J	50V	0402
C612	2320120	Top	M	4	chip cap X7R 22N K	25V	0603
C613	2360001	Top	M	4	chip cap X5R 330N K	10V	0603
C614	2320536	Top	K	2	chip cap NPO 10P J	50V	0402
C615	2320744	Top	K	2	chip cap X7R 1N0 K	50V	0402
C617	2320520	Top	M	3	chip cap NPO 2P2 C	50V	0402
C618	2320481	Top	M	2	chip cap X5R 1U K	6V3	0603
C619	2320552	Top	K	1	chip cap NPO 47P J	50V	0402
C621	2320744	Top	K	5	chip cap X7R 1N0 K	50V	0402
C624	2320536	Top	L	4	chip cap NPO 10P J	50V	0402
C627	2320540	Top	J	4	chip cap NPO 15P J	50V	0402
C629	2320532	Top	M	3	chip cap NPO 6P8 C	50V	0402

Item	Code	Side	X	Y	Description	Value	Type
C630	2320007	Top	M	4	chip cap NPO 16P J	50V	0402
C631	2320524	Top	M	4	chip cap NPO 3P3 C	50V	0402
C632	2320744	Top	M	4	chip cap X7R 1N0 K	50V	0402
C633	2320552	Top	K	4	chip cap NPO 47P J	50V	0402
C634	2320584	Top	L	5	chip cap X7R 1N0 J	50V	0402
C635	2320584	Top	K	4	chip cap X7R 1N0 J	50V	0402
C637	2320560	Top	M	3	chip cap NPO 100P J	50V	0402
C638	2320620	Top	M	4	chip cap X7R 10N J	16V	0402
C639	2320584	Top	L	1	chip cap X7R 1N0 J	50V	0402
C640	2320520	Top	K	3	chip cap NPO 2P2 C	50V	0402
C642	2320520	Top	K	3	chip cap NPO 2P2 C	50V	0402
C645	2320540	Top	J	3	chip cap NPO 15P J	50V	0402
C646	2320536	Top	L	4	chip cap NPO 10P J	50V	0402
C647	2320536	Top	L	4	chip cap NPO 10P J	50V	0402
C648	2320744	Top	K	1	chip cap X7R 1N0 K	50V	0402
C649	2320552	Top	K	2	chip cap NPO 47P J	50V	0402
C650	2320540	Top	I	3	chip cap NPO 15P J	50V	0402
C651	2320536	Top	K	4	chip cap NPO 10P J	50V	0402
C652	2320481	Top	M	5	chip cap X5R 1U K	6V3	0603
C653	2320744	Top	L	4	chip cap X7R 1N0 K	50V	0402
C660	2320536	Top	L	5	chip cap NPO 10P J	50V	0402
C666	2320552	Top	L	2	chip cap NPO 47P J	50V	0402
C701	2320783	Top	L	6	chip cap X7R 33N K	10V	0402
C702	2320584	Top	L	6	chip cap X7R 1N0 J	50V	0402
C704	2320778	Top	M	7	chip cap X7R 10N K	16V	0402
C706	2320778	Top	M	6	chip cap X7R 10N K	16V	0402
C707	2320778	Top	M	7	chip cap X7R 10N K	16V	0402
C708	2320778	Top	L	6	chip cap X7R 10N K	16V	0402
C710	2320778	Top	L	6	chip cap X7R 10N K	16V	0402
C712	2320778	Top	L	6	chip cap X7R 10N K	16V	0402
C714	2360001	Top	M	6	chip cap X5R 330N K	10V	0603
C715	2320620	Top	M	5	chip cap X7R 10N J	16V	0402

Item	Code	Side	X	Y	Description	Value	Type
C716	2320548	Top	L	5	chip cap NPO 33P J	50V	0402
C718	2320778	Top	M	7	chip cap X7R 10N K	16V	0402
C722	2320778	Top	L	7	chip cap X7R 10N K	16V	0402
C723	2320778	Top	M	7	chip cap X7R 10N K	16V	0402
C740	2320530	Top	D	7	chip cap NPO 5P6 C	50V	0402
C750	2320560	Top	D	7	chip cap NPO 100P J	50V	0402
C753	2320560	Top	D	7	chip cap NPO 100P J	50V	0402
C755	2320516	Top	B	5	chip cap NPO 1P5 C	50V	0402
C756	2320560	Top	D	7	chip cap NPO 100P J	50V	0402
C757	2320554	Top	C	5	chip cap NPO 56P J	50V	0402
C758	2320785	Top	C	5	chip cap X7R 47N K	10V	0402
C759	2320602	Top	D	5	chip cap NPO 4P7 C	50V	0402
C761	2320596	Top	H	5	chip cap X7R 3N3 J	50V	0402
C763	2320538	Top	C	7	chip cap NPO 12P J	50V	0402
C766	2320560	Top	C	5	chip cap NPO 100P J	50V	0402
C767	2320548	Top	I	5	chip cap NPO 33P J	50V	0402
C769	2320744	Top	D	7	chip cap X7R 1N0 K	50V	0402
C770	2320518	Top	H	8	chip cap NPO 1P8 C	50V	0402
C771	2320544	Top	L	7	chip cap NPO 22P J	50V	0402
C772	2320544	Top	L	7	chip cap NPO 22P J	50V	0402
C777	2320536	Top	H	8	chip cap NPO 10P J	50V	0402
C778	2320532	Top	H	8	chip cap NPO 6P8 C	50V	0402
C779	2320532	Top	H	9	chip cap NPO 6P8 C	50V	0402
C781	2320526	Top	G	9	chip cap NPO 3P9 C	50V	0402
C782	2320516	Top	I	5	chip cap NPO 1P5 C	50V	0402
C783	2320602	Top	G	8	chip cap NPO 4P7 C	50V	0402
C784	2320584	Top	F	8	chip cap X7R 1N0 J	50V	0402
C785	2320508	Top	B	7	chip cap NPO 1P0 C	50V	0402
C786	2320805	Top	G	8	chip cap X5R 100N K	10V	0402
C787	2320538	Top	C	6	chip cap NPO 12P J	50V	0402
C788	2320807	Top	C	7	chip cap X5R 100N K	10V	0402
C807	2320778	Top	H	3	chip cap X7R 10N K	16V	0402

Item	Code	Side	X	Y	Description	Value	Type
C808	2320584	Top	I	3	chip cap X7R 1N0 J	50V	0402
C809	2320540	Top	I	5	chip cap NPO 15P J	50V	0402
C810	2320584	Top	H	3	chip cap X7R 1N0 J	50V	0402
C811	2320556	Top	I	2	chip cap NPO 68P J	50V	0402
C813	2320552	Top	I	3	chip cap NPO 47P J	50V	0402
C814	2320560	Top	H	5	chip cap NPO 100P J	50V	0402
C817	2312255	Top	I	3	chip cap X5R 10U K	10V	1206
C907	2320556	Top	K	2	chip cap NPO 68P J	50V	0402
L100	3203743	Top	V	6	ferrite bead 0R03	42R/100MHz 3A	0805
L103	3203801	Bottom	W	3	chip bead array	2x10000R	0405
L120	3203801	Top	Q	7	chip bead array	2x10000R	0405
L121	3203801	Top	Q	7	chip bead array	2x10000R	0405
L122	3203801	Top	Q	7	chip bead array	2x10000R	0405
L270	3203723	Top	P	2	ferrite bead 0R35	68R/100MHz	0603
L271	3640091	Top	R	2	chip coil 15UH K 0.8A	6.5x5.3x2.0	
L501	3646007	Top	M	2	chip coil 27N J	Q27/800MHz	0402
L507	3646043	Top	J	5	chip coil 1N5 +-0N3	Q33/800M	0402
L603	3646015	Top	K	3	chip coil 8N2 J	Q7/100MHz	0402
L604	3646015	Top	K	4	chip coil 8N2 J	Q7/100MHz	0402
L609	3646009	Top	L	4	chip coil 10N J	Q30/800MHz	0402
L610	3646009	Top	K	4	chip coil 10N J	Q30/800MHz	0402
L611	3645219	Top	M	4	chip coil 10N J	Q31/250MHz	0603
L666	3646001	Top	L	4	chip coil 3N3 +-0N3	Q7/100M	0402
L667	3646045	Top	L	5	chip coil 1N8 +-0N3	Q8/100M	0402
L701	3645223	Top	L	6	chip coil 33N J	Q40/250MHz	0603
L750	3646415	Top	B	6	chip coil 19N J	Q24/250MHz	0402
L751	3646405	Top	B	6	chip coil 6N2 J	Q20/250MHz	0402
L752	3646019	Top	C	5	chip coil 15N J	Q7/100MHz	0402
L753	3645351	Top	C	5	chip coil 220N J	Q8/50MHz	0603
L754	3645195	Top	H	5	chip coil 82N J	Q12/100MHz	0603
L755	3646019	Top	C	6	chip coil 15N J	Q7/100MHz	0402
L757	3646019	Top	C	5	chip coil 15N J	Q7/100MHz	0402

Item	Code	Side	X	Y	Description	Value	Type
L759	3645243	Top	H	8	chip coil 47N J	Q38/200MHz	0603
L760	3645229	Top	L	7	chip coil 120N J	Q32/150MHz	0603
L761	3645229	Top	L	7	chip coil 120N J	Q32/150MHz	0603
L762	3645195	Top	G	8	chip coil 82N J	Q12/100MHz	0603
L764	3645301	Top	G	8	chip coil 180N J	Q13/100MHz	0603
L765	3645229	Top	H	8	chip coil 120N J	Q32/150MHz	0603
L766	3645229	Top	H	9	chip coil 120N J	Q32/150MHz	0603
L767	3645319	Top	I	8	chip coil 220N J	Q25/100MHz	0603
L768	3645319	Top	I	9	chip coil 220N J	Q25/100MHz	0603
L769	3646065	Top	D	7	chip coil 12N J	Q31/800MHz	0402
L770	3645195	Top	D	5	chip coil 82N J	Q12/100MHz	0603
L771	3646011	Top	D	6	chip coil 4N7 +-0N3	Q7/100M	0402
L773	3646099	Top	C	7	chip coil 2N7 +-0N3	Q29/800M	0402
L801	3645191	Top	G	3	chip coil 8N2 J	Q10/100MHz	0603
L802	3646039	Top	H	3	chip coil 5N6 +-0N3	Q7/100M	0402
L805	3646421	Top	V	2	chip coil 1N0 K	Q16/250MHz	0402
V001	4210189	Bottom	H	6	TR BFP620 N2.5V 70GHz	F=0.7	SOT343
V100	4113721	Top	V	6	tv di 1PMT16AT3	16V 175W	PWRMITE
V101	4120011	Bottom	W	5	zdix4 IP4043CX5 CA	14V2 10W	CSP5
V152	4120061	Bottom	W	4	ASIP 2-lines EMI/ESD	filter	BGA6
V153	4120061	Top	B	8	ASIP 2-lines EMI/ESD	filter	BGA6
V154	4120011	Top	Q	8	zdix4 IP4043CX5 CA	14V2 10W	CSP5
V270	4110441	Top	Q	2	sch di STPS0520Z	20V 0.5A	SOD123
V303	4860451	Bottom	L	4	LED CL510 White		600MCD
V304	4860451	Bottom	L	2	LED CL510 White		600MCD
V305	4860451	Bottom	L	6	LED CL510 White		600MCD
V306	4860451	Bottom	L	8	LED CL510 White		600MCD
V309	4864543	Bottom	V	4	LED CL270WB-D White	90' VF < 4.0V	
V310	4864543	Bottom	V	6	LED CL270WB-D White	90' VF < 4.0V	
V420	4219921	Top	R	5	TR DTC143ZE N RBE4K7	47K 0A1	SC75
V421	4219921	Top	P	5	TR DTC143ZE N RBE4K7	47K 0A1	SC75
V422	4219921	Top	Q	5	TR DTC143ZE N RBE4K7	47K 0A1	SC75

Item	Code	Side	X	Y	Description	Value	Type
V500	4210100	Top	M	8	TR BC848W N 30V	0.1A 100MHz	SOT323
V601	4110921	Top	M	5	cap di BBY57-02W	1/4 16/4P	SOD523
V602	4112491	Top	M	3	pin di BA892 0A1	0R7@1MA	SCD-80
V701	4110921	Top	L	5	cap di BBY57-02W	1/4 16/4P	SOD523
Z300	4120031	Top	T	5	EMI/ESD filt EMIF10-	1K010F1	BGA24
Z601	4511331	Top	J	4	Dual saw filt 1867/1892	+/-17.5MHz	
Z604	4511275	Top	J	2	Saw filt 836.5+/- 12.5MHz	3.5DB	3x3
Z750	4511295	Top	C	7	Saw filt 1960.0MHz	3.7DB	3x3x1
Z751	4511309	Top	C	5	Saw filt 881.5+/- 12.5MHz	3DB	2.5x2
Z752	4510359	Top	G	8	XTAL filt 128.1MHz+/-	15KHz	3.8x3.8
Z753	4511329	Top	H	7	Saw filt 128.1+/-	0.61MHz	9x5x1.6
Z801	4510361	Top	G	3	Isolator 1880+/-30MHz	15DB	4x4x2
Z802	4510381	Top	G	2	Isolator 836+/-12.5	13DB	5x5x2.0
Z803	4512175	Top	F	2	Dupl 824-849/869-	894MHz	5x5x1.5
Z804	4512159	Top	E	5	Dupl 1850-1910/1930-	1990MHz	24x7
Z805	4550117	Top	C	4	Dipl 824-894/1850-	1990MHz	3.2x1.6
N100	4341269	Bottom	W	6	VREG 2.8V/150MA	(LP3985)	USMD5
N150	4341221	Top	R	8	AF AMP 0.4W/2.6V	(LM4890)	USMD9
N270	4341255	Top	P	1	VREG PWM/LDO	(NCP1500)	MSOP8
N502	4341295	Top	L	1	RF AMP G5.5DB/2.1GHz	(ULOPA)	SC70-6
N601	4370857	Top	L	3	Robind SSBUP-con- verter	CDMA	TFBGA
N602	4370887	Top	K	4	Hornet RF2357E7	PCS driver amp	
N603	4370885	Top	K	1	Tomcat RF2356E4	CDMA 2000	SOT23-8
N701	4370851	Top	L	7	Batmand RFIC RCVR	CDMA	UFBGA84
N750	4370863	Top	C	6	Alfred LNA/Mixer/		VQFN-24
N801	4350419	Top	I	2	pw amp CX77134-16		CDMA2000
N802	4350395	Top	H	4	pw amp 1850-1910M		SNAPPER
N805	4341413	Top	J	3	SW SPDT DC-3.0GHz	(CSH210R)	SC70-6
N806	4120091	Top	H	3	ASIP STPAC01-F1	CDMA pwr det	BGA8
N807	4341395	Top[J	8	1XPLL/SYNTH 2.5GHz	(LMX2310U)	MLF20
D200	4370825	Top	P	6	UEMK W-DOG ENA T021		TFBGA168

Item	Code	Side	X	Y	Description	Value	Type
D400	4370873	Top	Q	3	UPP8M V2.2 F751986B	C035	UBGA144
D450	4341441	Top	O	3	Combo 64M NOR+4M	SRAM	TBGA48
D451	4341397	Top	N	5	White LED driver	(LM2795BLX)	USMD14
G501	4510347	Top	L	8	VCTCXO 19.2MHz+-	1.5ppm	2.7V
G502	4350329	Top	J	6	VCO 986-1034/2040-	2140MHz	2.7V
B002	4510403	Bottom	E	8	TCXO 16.368MHz+-	15ppm 2.8V	GPS
B200	4510303	Top	Q	8	Crystal 32.768KHz+-	20ppm	12.5PF
T603	4550211	Top	L	4	Transf balun 1850-1990MHz		SMD
T604	4550209	Top	K	3	Transf balun 824-894MHz		SMD
F100	5119019	Top	V	6	Sm fuse F	1.5A 32V	0603
S301	5209001	Top	A	6	Sm SW tact SPST	12V 50MA	Side Key
X002	9510434	Top	C	8	Spring clip M3E14601	NSJ-3	HD925
X003	9510434	Top	D	8	Spring clip M3E14601	NSJ-3	HD925
X101	5460061	Top	W	4	Sm system connector		14POL
X814	5429021	Bottom	B	2	Sm Conn RF+SW	100V 1W 50R	2.2GHz
A101	9517250	Top	C	6	LNA can assy	DMC05933	0.20MM
A102	9510686	Top	E	5	Duplexer shield	DMD07064	HDA A3
A103	9517249	Top	K	7	Can assy RX	DMC05934	0.20MM
A104	9517154	Top	I	3	RF can assy TX	DMC04293	HDBA2
A105	9517156	Top	P	5	BB can assy	DMC04292	HDBA2

